

Power and low-voltage wires behind removable base;

Connections to wall terminations are made behind the removable baseboard, allowing outlets anywhere, anytime.

Notes:

- ① "Slack" in distribution lines as needed.
- ② Under door channel is possible.
- ③ One or more circuits in plastic conduit to each room.
- ④ One or more low voltage lines in plastic conduit.

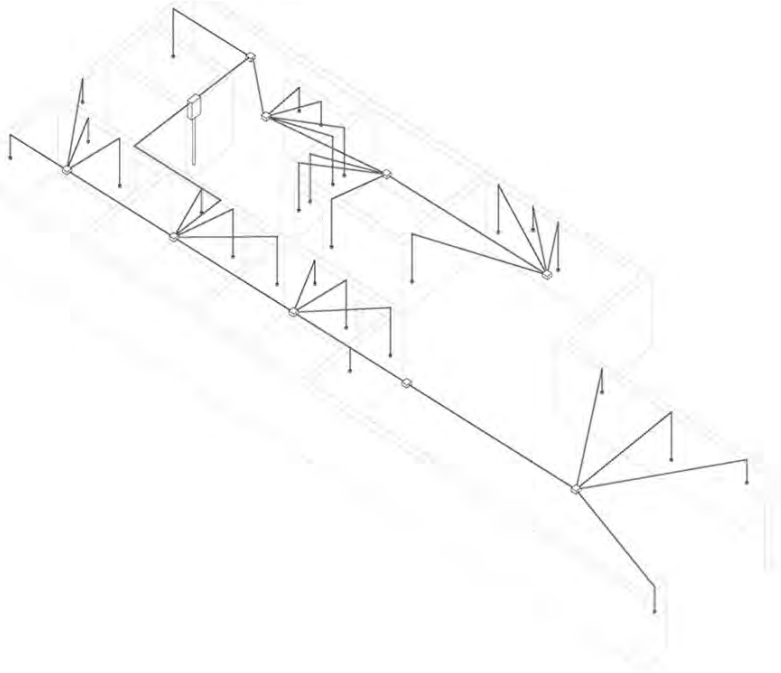

■ Conventional wiring layout

Wires from the circuit breaker panel are usually run in the ceiling, then down in the walls to each electrical outlet, or horizontally and then up to the ceiling and down again, between outlets and between switches and lighting fixtures.

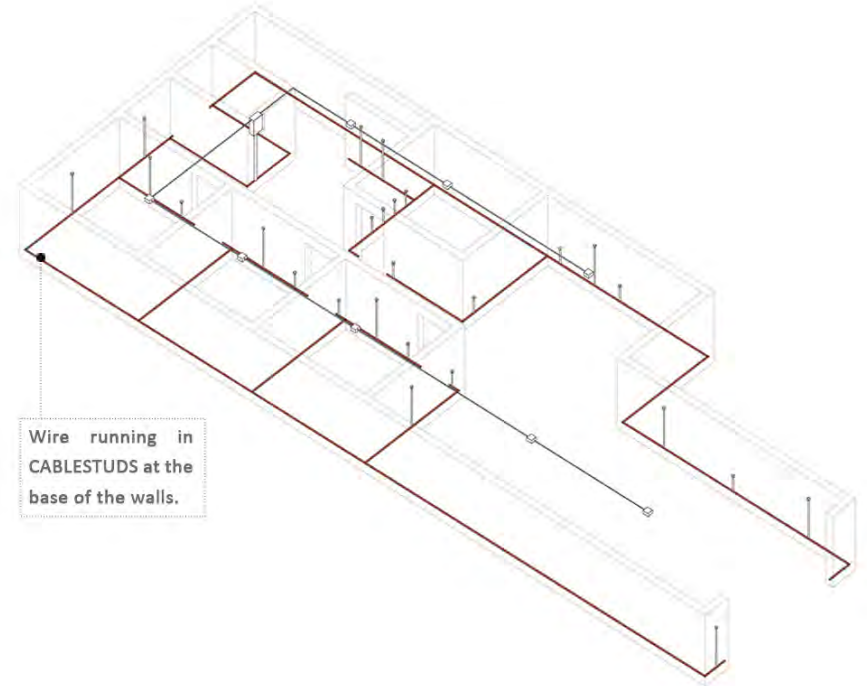

■ In a CABLESTUD installation

Wires from the circuit breaker panel are run in the CableStud space at the base of the wall, then UP to each switch or outlet. Wires for ceiling lighting fixtures are in the ceiling, and switching can be by remote control or hard wired.

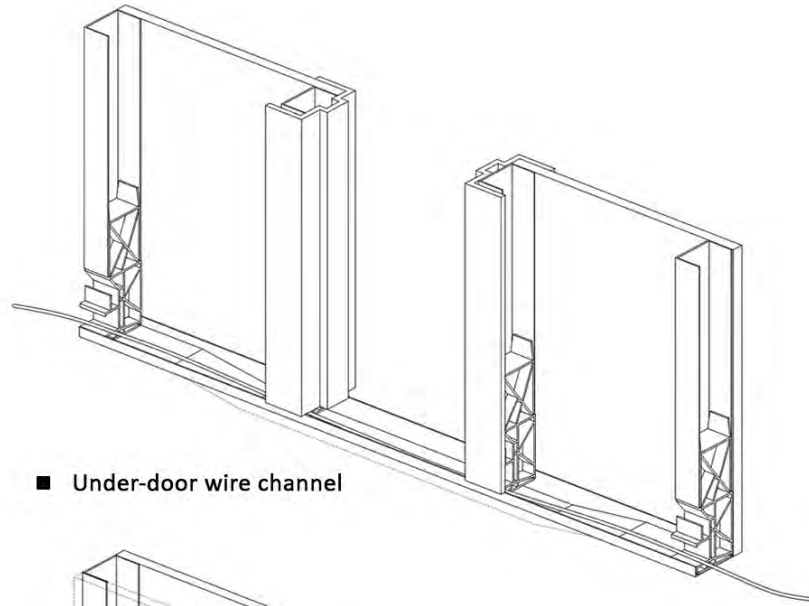

■ Under-door wire channel

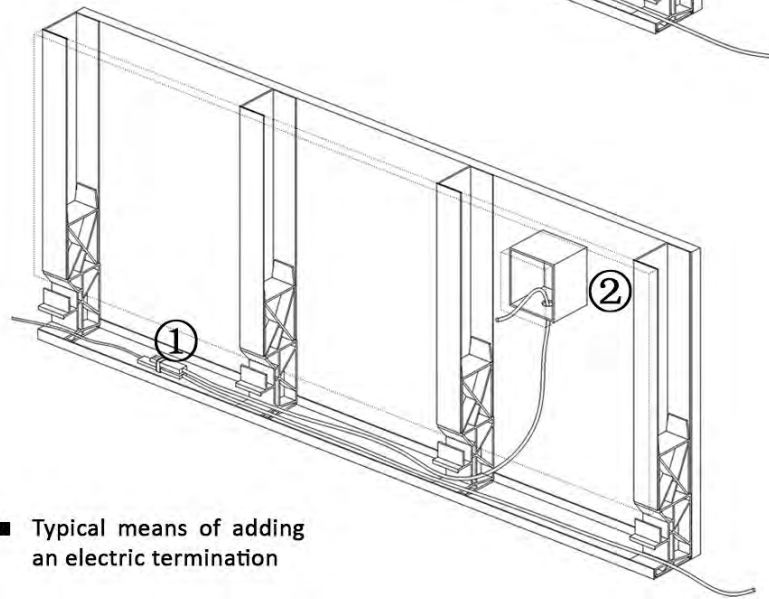

■ Typical means of adding an electric termination

Electric outlet added later with 3 meters cable, running over to a connector block, installed initially at 3 meters intervals. (cables with plugs at each end are 3 meters long +/-)

Notes:

- ① Connector block.
- ② "Rework" electrical box installed after wall panel is in place.

